



CrewShow

PALMA DE MALLORCA Thursday 26 March 2015
Friday 27 March 2015



THE BOATHOUSE
PALMA  SPAIN

Time well spent!

**CASUAL DOCKSIDE DINING
CAFE · BAR · BISTRO
24 HOUR PARKING**

open all day every day 971 73 41 14 theboathouse.es
BRING THIS IN FOR A 2.4.1 COCKTAIL : ONE PER CUSTOMER

Exhibitor Guide

Event information

This is the 6th annual Dovaston Crew Show and the new owners have created a greater more international event to greet the summer.

We are hosting an event to Crew of all yachts from deckhands to Captains, engineers and interior giving them further insight to suppliers, provisioners, trainers and industry businesses available for their requirements as professionals and during their free time.

After receiving some great feedback from last year's event we have undertaken the following:-

- A larger location (525m²) which is more central to Palma and the majority of marinas.
- Just 10 minutes from the international airport of Son Sant Joan.
- Created a 2 day event to give more exposure to those companies coming from outside of Mallorca.
- Presentation lounge for workshops and new concepts coming to the industry
- Complimentary Wi-Fi.
- A large restaurant and terrace area with casual dockside dining.
- Quiet Meeting zone.
- Cocktail Party, Thursday 26th 5.30 pm – Invitation Only-
- Evening Security.

CrewShow Opening Hours

Thursday 26th March 2015 10:00 – 20:00

Friday 27th March 2015 10:00 – 18:00

The Boat House, Palma

Set-up can begin on Wednesday 25th from 6 pm/ Breakdown shall be Friday 27th from 6 pm.

Exhibitor Stands & Packages

We are offering a number of packages for exhibitor's to choose from:

Premium Package (2 days) 10 available

As part of the premium package you will receive:

- Three (150cm) tables;
- 10m² floor space (5m x 2m);
- Seating (4 chairs);
- Bottled water (2L.);
- Unlimited electricity supply;
- Unlimited Wi-Fi;
- Company information and logos will appear on the dedicated website;
- Opportunity to give a 30 minute presentation talk of your choice;
- Complimentary Boat House voucher for their specially prepared lunch Menu for 3 exhibitors per day including a beverage;
- 6 Complimentary drinks vouchers per day;
- Invitation to the cocktail party on the Thursday evening;
- BBQ dinner on the Friday evening for 2 at the closing event.

Cost: 1,400€

Standard Package (2 days) 30 available

As part of the standard package you will receive:

- Two (150cm) tables;
- 8m² floor space (4m x 2m);
- Seating (3 chairs);
- Bottled water (2L.);
- Unlimited electricity supply;
- Unlimited Wi-Fi;
- Company information and logos will appear on the dedicated website.
- Complimentary Boat House voucher for their specially prepared lunch Menu for 2 exhibitors per day including a beverage.
- 4 Complimentary drinks vouchers per day.

Cost: 800€

Junior Package (1 or 2 days) 20 available

As part of the junior package you will receive:

- One (150cm) table;
- 4m² floor space; (2m x 2m)
- Seating (1 chair);
- Bottled water (2L.);
- Unlimited electricity supply;
- Unlimited Wi-Fi.
- 2 complimentary drink vouchers per day.

Cost: 1 day 350€

2 days 600€

Table only (1 or 2 days) 5 available

An unmanned stand will compromise of:

- Shared (150cm) table;
- This stand will be decorated as per the client's instructions and will be checked regularly and kept presentable. All unused literature will be returned at a cost depending upon location.

Cost: 150€ per day

Exclusive Sponsorship Opportunities

Lunch Sponsorships

- Sponsorship of Lunch on Thursday or Friday.
- Company Banners.
- Leaflets and Brochures on full show.
- Company Logo & Link on Dovaston Crew & CrewShow websites.

Cost 750€

Friday Evening BBQ Event 6 pm – 9 pm

- Sponsorship of BBQ on Friday evening
- Company banners on BBQ area
- Leaflets and Brochures
- Company Logo & Link on Dovaston Crew & CrewShow websites

Cost 1,000€

Music Sponsorship

- Music event with Singers and DJ.
- Company Banners, Leaflets and Brochures on stage & surrounds.

Cost 500€

Educational talks

We shall have a representative from the major shipping's agent Balearics Port Authority to discuss topical issues within the industry and these cruising zones.

ACREW will be hosting 2 workshops per day.

Dovaston Crew Plus will have a presentation.

We will have a room available and bookable should you desire to host a small presentation showcasing your product.

This area is bookable for 100€ per 45 min.

Package Booking

Once you have selected your package, please visit www.crewshow.com and complete the provisional online booking form.

One of our team will then contact you to confirm your requirements for the day.

All prices are VAT exclusive.

Venue information

The Boat House is located in the heart of Palma's Paseo Marítimo, opposite the Auditorium and is easily accessible.

Venue address:

The Boat House

Estación Marítima de las Golondrinas

Avenida Gabriel Roca

07014 Palma de Mallorca

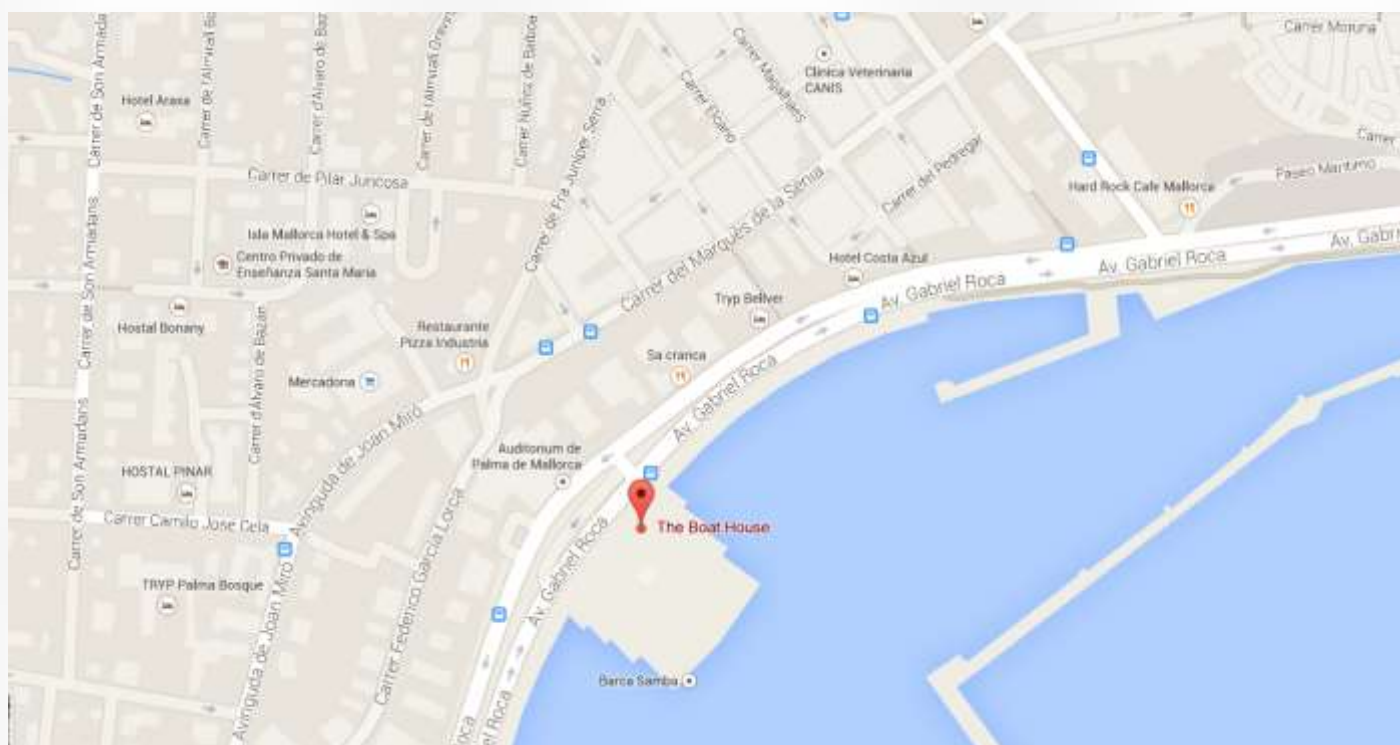

Floorplan

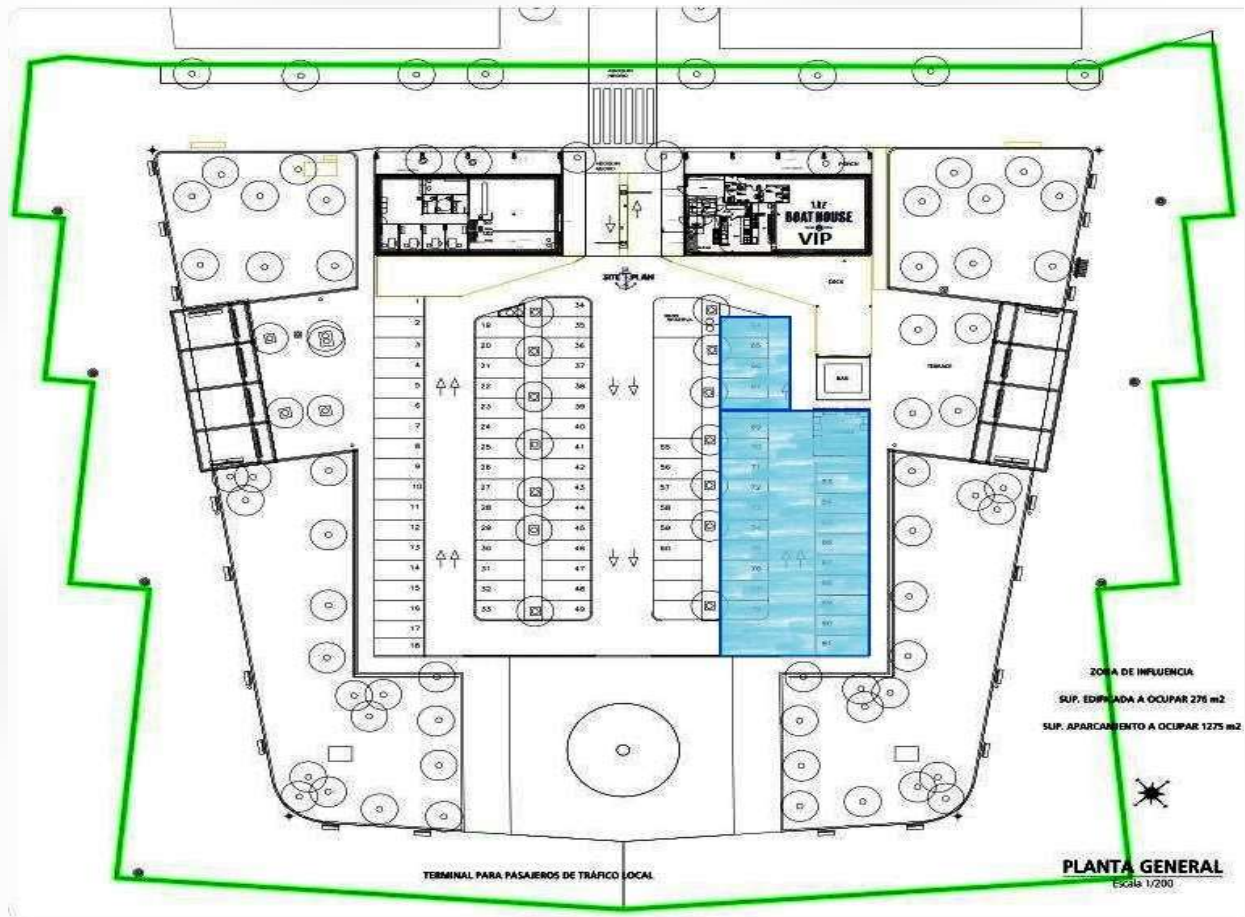

Travelling to the Venue

By car

The Boat House is situated within easy access from the city centre. Is opposite the Auditorium and there is a public and private parking nearby.

By public transport

The nearest bus stop (number 30) is a 1 minute walk.

There are many bus stops near the venue which cover several routes in and around Palma.

Refreshments and Food of the Day

- Food and drinks vouchers are available.
- Morning Coffee and croissant deal 3€ up to 11 am.
- Daily lunch menu of 12.50€.
- Cocktail party menu 7€.
- Drinks offer for crew and exhibitors, wine and beer 3€ each.
- Buckets of beer available.

Hotels

We are working with some of the best hotels within Palma and the surrounding zones if you desire assistance.

Deliveries

All deliveries of printed literature or stand equipment must be booked in prior to the Crew Show date. This is to ensure that all items that are required on the days of the event can arrive safely and on time.

All deliveries must arrive at the following address between Monday 16th and Friday 20th March 2015 and between hours of 09:00 am and 05:30 pm:

Dovaston Crew SLU

C/Saridakis, 2 Local 1 Bajos
07015 Palma de Mallorca
Spain

All packages must have the event label clearly visible so that they can be sorted prior to the event. Please print off and complete the label and attach to each individual package before shipping.

All packages will be returned after the event via courier. Prices will be confirmed at the time of return.

Delivery Label

Please print off and complete the label and attach to each individual package before shipping:

DELIVERY LABEL	
Event name:	Crew Show 2015
Total number of boxes:	
Sender's name & company:	